

IT-SSA5-WL

With 5 high power LEDs for a total power consumption of 8W, beam angle 60°, beam distance 1m to 10m, the IT-SSA5-WL is a White Light Illuminator with a high service of life.

- Luminous flux 910lm.
- Color temperature 5500-6500K.
- 50,000 hours lifetime LEDs.
- Extended working temperature range -20 to 50°C.
- 1-3 years warranty.



Product Family

The IT-SSA5-WL is part of the high-power Compact White Light Illuminators series that is the quality LED light source solution for night-time illumination, providing high-power light for CCTV and IP cameras to enhance night-time visual performance with colorful images.

Product Features

- Die casting aluminum housing, strong and durable.
- One piece forming lens, uniform light spot and delicate.
- Support power adjust.
- Support light sensor sensitivity adjust.
- Anti-dazzle panel optional, less influence of human eye.
- IP66 waterproof.

Basic Functions

- *To improve performance of the weak light camera, thereby enhancing the picture effects at night.*
- *Conventional night monitoring.*
- *The function of video analysis at night.*
- *Reduce signal noise and other image distortion.*
- *Reduce the network bandwidth requirements.*
- *Energy saving by power factor correction.*
- *Reduce the equipment cost.*
- *Lower cost of installing and wiring.*
- *Indoor and outdoor use.*

Technical Specifications

LED type: 5 pieces high power white light LEDs

Luminous flux: 910lm

Color temperature: 5500-6500K

Beam angle: 60°

Beam distance: 1m to 10m

Bracket: Wall mount bracket

Working voltage: AC220V

Power consumption: <8W

Day & Night switch: 0-50 LUX adjustable

Brightness adjust: 5%-100% adjustable

Working temperature: -20°C to 50°C

Protection level: IP66

Color: White

Panel: Tempered glass

Housing: Aluminum die-casting housing

Net weight: 0.65 kg

Gross weight: 0.8 kg



Models for Selection

Model	Beam angle	Viewing distance
IT-SSA5-WL-60-W	60°	1m - 10m

**Viewing distance is tested by Sony 1/3 CCD Camera with 0.01 LUX.*

To achieve the distance needed, please pay attention to your camera specifications and lens before purchase. It is normal phenomenon that distance may vary due to different cameras and lens.

Mechanical Drawings

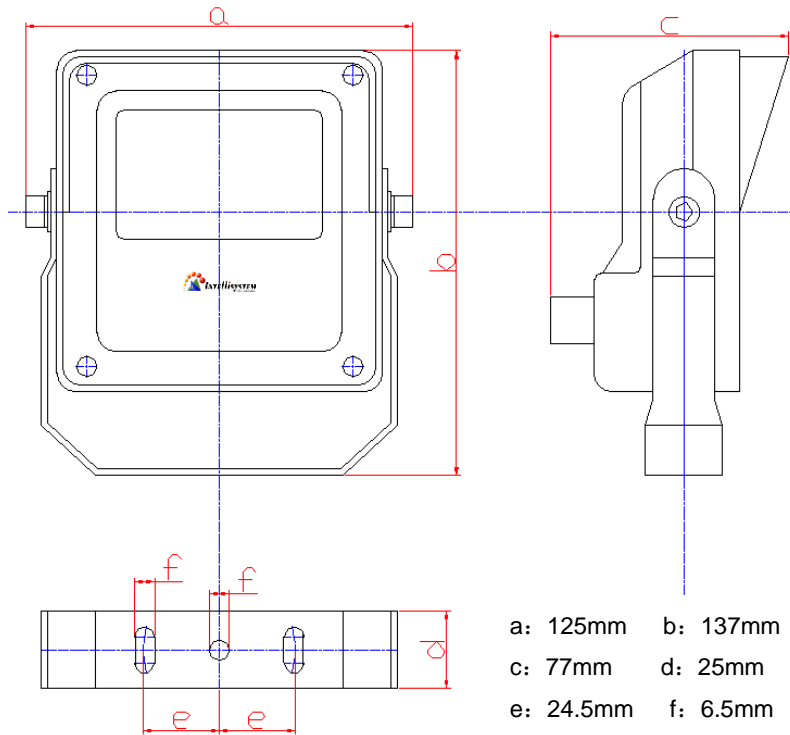

Viewing Picture at Night



With white light



Without white light